

# Welcome to Frankfurt



DOUBLETREE  
by Hilton™



# location

- Ideal location at the „Lyoner Viertel“, one of the most attractive office locations in the Rhine-Main-Area
- 5 km to the main station Frankfurt am Main
- 9 km to the international airport Frankfurt (FRA)
- 6 km to the stadium „Deutsche Bank Park“
- Great transport connection to public transport (tram, suburban railway and bus)



# rooms

- 146 modern rooms and suites with king- or queensize beds
- Bathrooms with shower or bathtub
- Air condition
- Coffee- and tea facilities as well as a minibar fridge
- Desk
- Safe



DOUBLETREE  
by Hilton™



# conference facilities



DOUBLETREE  
by Hilton™

- 3 meeting rooms from 68 to 156 m<sup>2</sup>
- Space for up to 130 guests in the largest room
- Flexible interior design through mobile walls
- canvas und data projector
- The rooms are free of columns and provide daylight
- All rooms are located on the same floor (ground floor)



# floorplan



DOUBLETREE  
by Hilton™

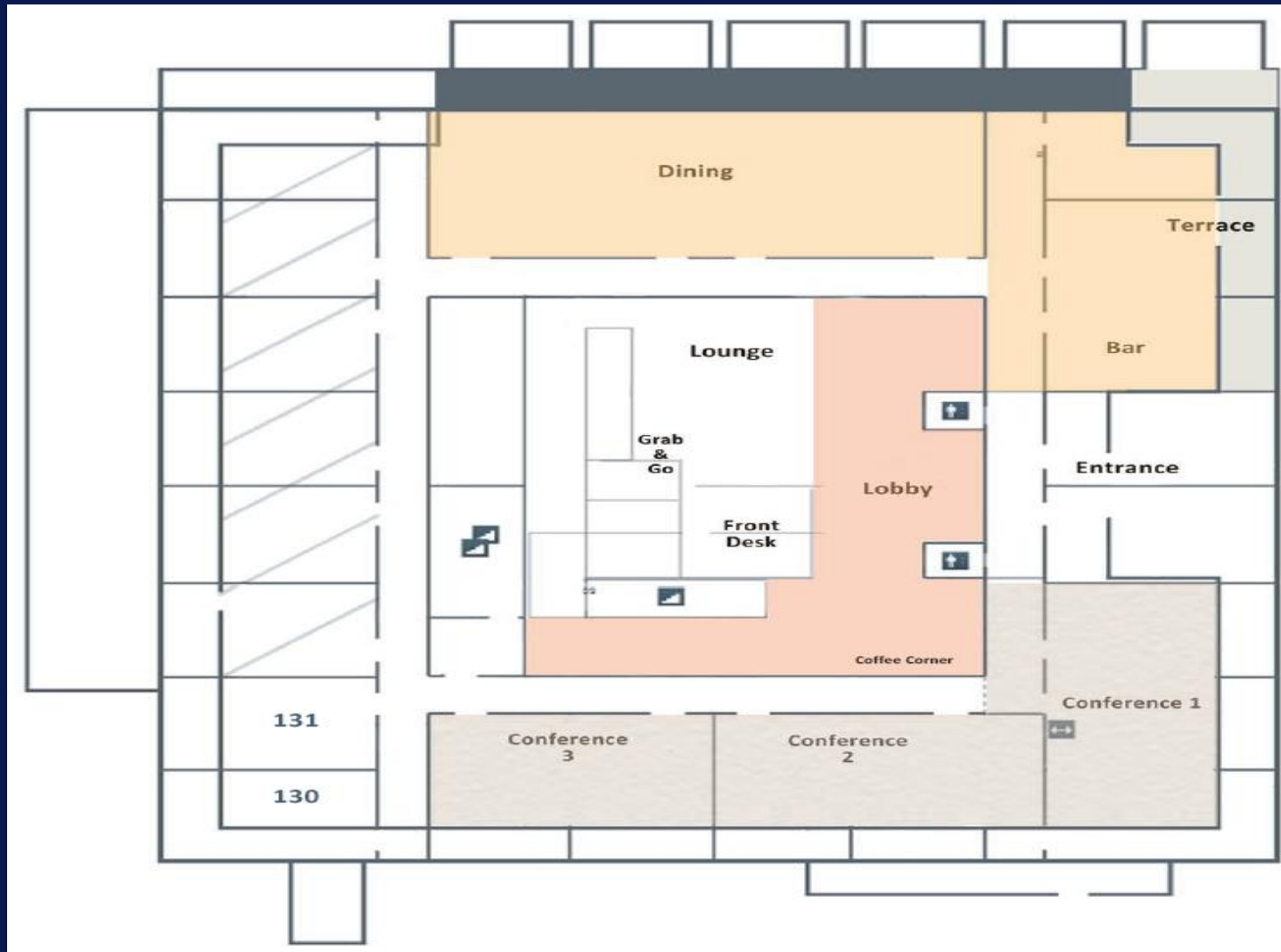



# restaurant & bar

- Open restaurant and bar concept with 80 seats
- Plenty of daylight through huge windows
- Terrace to linger in summer
- Exclusive booking possible

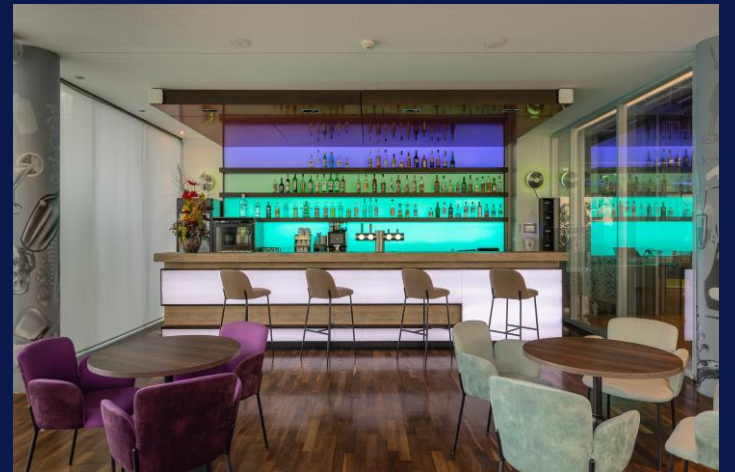

Our weekly changing  
lunch menu

# further advantages



- 24/7 gym
- WIFI in the whole hotel without costs
- Parking spaces directly at the hotel (21 EUR/day)
- Hilton Honors – Loyalty Reward Program  
<https://www.hilton.com/en/hilton-honors>



# impressions



DOUBLETREE  
by Hilton™

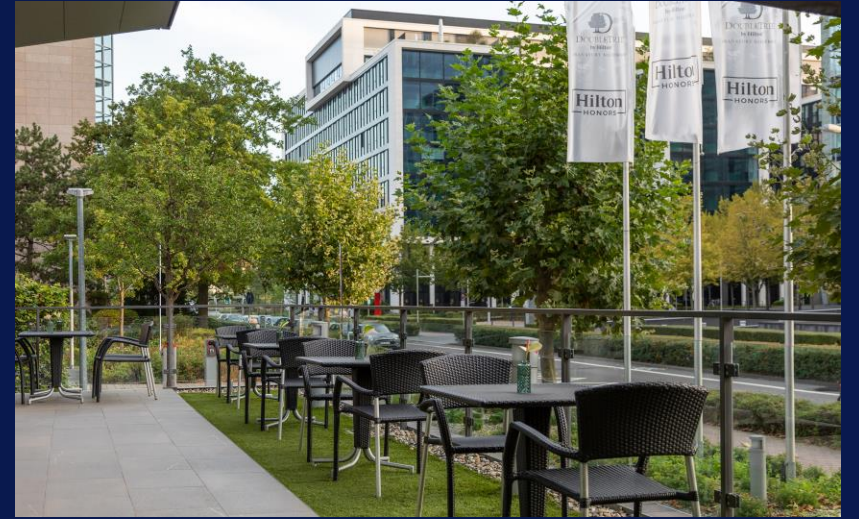



**Thank you**

